



Democratic Services

Location: Phase II
Ext: 0833
DDI: 01895 250833
CMD No: 285

**To: COUNCILLOR JOHN RILEY
CABINET MEMBER FOR PUBLIC SAFETY AND
TRANSPORT**

c.c. All Members of the Public Safety & Transport
Select Committee
c.c. Ward Councillors for Heathrow Villages
c.c. Perry Scott – Infrastructure, Transport & Building
Services
c.c. Caroline Haywood – Infrastructure, Transport &
Building Services
c.c. Conservative and Labour Group Offices
(inspection copy)

Date: 23 September 2021

Non-Key Decision request

Form D

HARMONDSWORTH LANE, SIPSON - OBJECTION TO PROPOSED WAITING RESTRICTIONS

Dear Cabinet Member

Attached is a report requesting that a decision be made by you as an individual Cabinet Member. Democratic Services confirm that this is not a key decision, as such the Local Authorities (Executive Arrangements) (Meetings and Access to Information) (England) Regulations 2012 notice period does not apply.

You should take a decision **on or after Friday, 1 October 2021** in order to meet Constitutional requirements about publication of decisions that are to be made. You may wish to discuss the report with the Corporate Director before it is made. Please indicate your decision on the duplicate memo supplied and return it to me when you have made your decision. I will then arrange for the formal notice of decision to be published.

Jack Roberts
Democratic Services Apprentice

**Title of Report: HARMONDSWORTH LANE, SIPSON - OBJECTION TO
PROPOSED WAITING RESTRICTIONS**

Decision made:

Reasons for your decision: (e.g. as stated in report)

Alternatives considered and rejected: (e.g. as stated in report)

SignedDate.....
Cabinet Member for Public Safety and Transport

HARMONDSWORTH LANE, SIPSON - OBJECTION TO PROPOSED WAITING RESTRICTIONS

Cabinet Member(s)	Councillor John Riley
Cabinet Portfolio(s)	Cabinet Member for Public Safety and Transport
Officer Contact(s)	Caroline Haywood, Infrastructure, Transport and Building Services
Papers with report	Appendices A - C

HEADLINES

Summary	To inform the Cabinet Member that objections have been received to the proposed limited waiting restrictions on Harmondsworth Lane, Sipson.
Putting our Residents First	The request can be considered as part of the Council's annual programme of road safety initiatives.
Financial Cost	The cost associated with the recommendations to this report is estimated at £1,444 and will be met from within existing revenue budgets for the Transportation Service.
Relevant Select Committee	Public Safety and Transport Select Committee.
Relevant Ward(s)	Heathrow Villages.

RECOMMENDATIONS

That the Cabinet Member for Public Safety and Transport:

1. considers the objections received from the statutory consultation for the proposed limited waiting restrictions on Harmondsworth Lane, Sipson; and
2. approves the revised proposal for the introduction of limited waiting restrictions operational Monday to Friday 10am - 3pm on Harmondsworth Lane.

Reasons for recommendations

To improve access on Harmondsworth Lane whilst still maintaining parking for residents in the evenings and weekends.

Alternative options considered / risk management

The Council could decide not to proceed with the installation of the limited waiting restrictions as advertised.

Select Committee comments

None at this stage.

SUPPORTING INFORMATION

1. Harmondsworth Lane is a combination of residential and rural areas within Heathrow Villages Ward. It is used as a route to connect Sipson Village with Harmondsworth Village and has Heathrow Primary school located at its eastern end. A plan of the area is shown on Appendix A to this report.
2. The Council received a request from the Residents Association through the Road Safety Programme for measures to remove obstructive parking along the length of the rural section of Harmondsworth Lane. Consequently, a detailed site investigation was undertaken by Council officers.
3. Officers observed that there are sections of existing double yellow lines which help to improve access. Vehicles are parking on one side of the road which reduces the carriageway to one lane. A high number of these parked vehicles are parked for many days and some are taxi drivers due to the close proximity of Heathrow Airport.
4. As a result of the site observations, a proposal was developed to install single yellow lines on both sides of the road operational Monday – Friday, 10am – 3pm. This will allow residents to park in the road in the evening and at weekends. It will also allow parents to park when dropping off and picking up at Heathrow Primary School. The proposed waiting restrictions are shown on the plan attached as Appendix B of this report.
5. The Cabinet Member agreed to take the proposal through the statutory 21-day consultation process, which involved the placing of advertisements in the local press and the display of public notices on site. During this period the Council received one objection and one email of support.
6. The objector stated *"Since the introduction of limited residents on-street parking, we find that or visitors have no option but to park further down the lane. The proposed yellow lines will make it difficult for visitors and resident to find extra parking. The issue with the obstructive parking will not be resolved with the yellow lines as most of this is caused by taxi, chauffeur or delivery vehicles, whose drivers tend to stay in their vehicles hence*

making the yellow line ineffective as they will merely move the car further down the lane when traffic enforcers come. The proposed yellow lines will only have a negative effect on the residents and for that reason I would like to object to the proposal. If a yellow line is to go forward I would like to request that you leave 30m of parking from No 62 Harmondsworth Lane for the use of residents and visitors."

7. The supporter stated *"I most strongly support. I have seen in recent years ever increasing obstructive parking in the lane mainly comprising airport public hire vehicles and airport parking companies using it as an unofficial car park plus airport workers parking there then taking the U3 or 350 bus into the airport.....every school holiday sees cars parked bumper to bumper along parts of the lane put there by airport parking companies. These restrict parts of the lane to single file and also are sometimes parked up on the pavement blocking pedestrian access. In addition to the frequency of them parking in the lane, the minicabs result in an immense amount of rubbish being thrown out their cars littering the lane. Some drivers also use the lane as a toilet....If these parking restrictions are put in place then they will only be effective if regularly patrolled by parking wardens. We have residential parking....but that does stop some mini cabs still waiting in these spaces. If there is not regular patrolling of the lane then such new parking restrictions and residents parking spaces will be abused....."*
8. Taking into consideration the objector's comments, it is feasible to leave 30m of road unrestricted to allow visitors and residents to park during the day. This should not adversely restrict access.
9. The local Ward Councillors have been consulted and one has responded supporting the amendment to leave 30m of the road unrestricted.
10. After careful consideration of comments received from the statutory consultation and the views of the local Ward Councillors; it is recommended that the Cabinet Member agrees to proceed with the revised proposed limited waiting restrictions in Harmondsworth Lane as shown in Appendix C to this report.

Financial Implications

The cost associated with the recommendations to this report is estimated at £1,444 and will be met from within existing revenue budgets for the Transportation Service.

RESIDENT BENEFIT & CONSULTATION

The benefit or impact upon Hillingdon residents, service users and communities?

The effect of introducing the proposed waiting restrictions on Harmondsworth Lane will be that safety is maintained whilst maintaining parking for residents.

Consultation carried out or required

Consultation has been carried out on this proposal through a notice on site and in the local press. Local Ward Councillors have also been consulted.

CORPORATE CONSIDERATIONS

Corporate Finance

Corporate Finance has reviewed the recommendations to this report and concurs with the financial implications as set out above.

Legal

The Borough Solicitor confirms that there are no legal impediments to the Cabinet Member agreeing the recommendations set out in the report which are in accordance with the outcome of the statutory consultation.

Infrastructure / Asset Management

There are no property implications resulting from the recommendations set out in this report.

Comments from other relevant service areas

None at this stage.

BACKGROUND PAPERS

- Traffic order
- Objection emails

TITLE OF ANY APPENDICES

Appendix A - location plan
Appendix B - plan of proposal
Appendix C – revised proposal

Appendix A - location plan

APPENDIX A

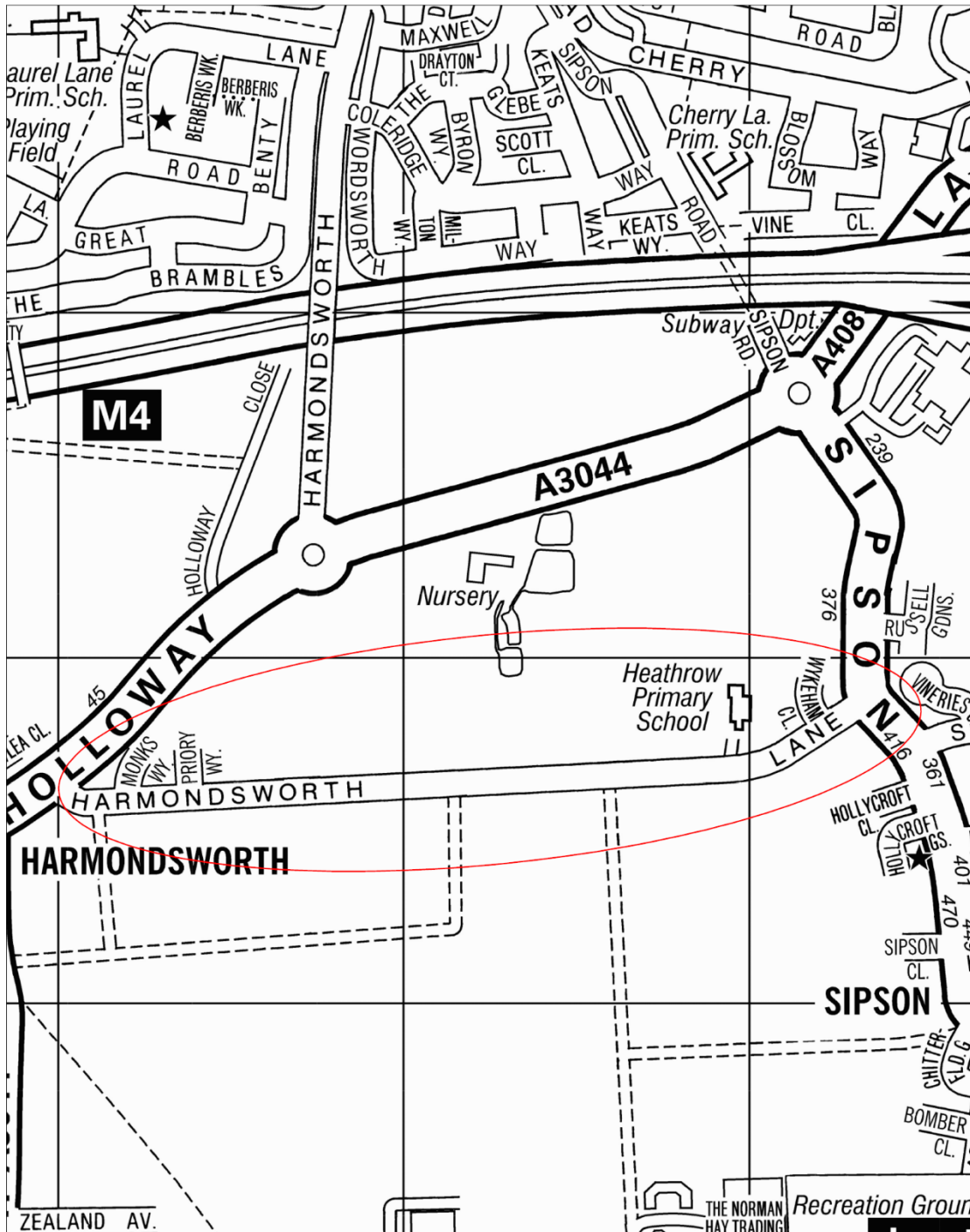

© Crown copyright and database rights 2021 Ordnance Survey 100019283

 Harmondsworth Lane

Appendix B No 2

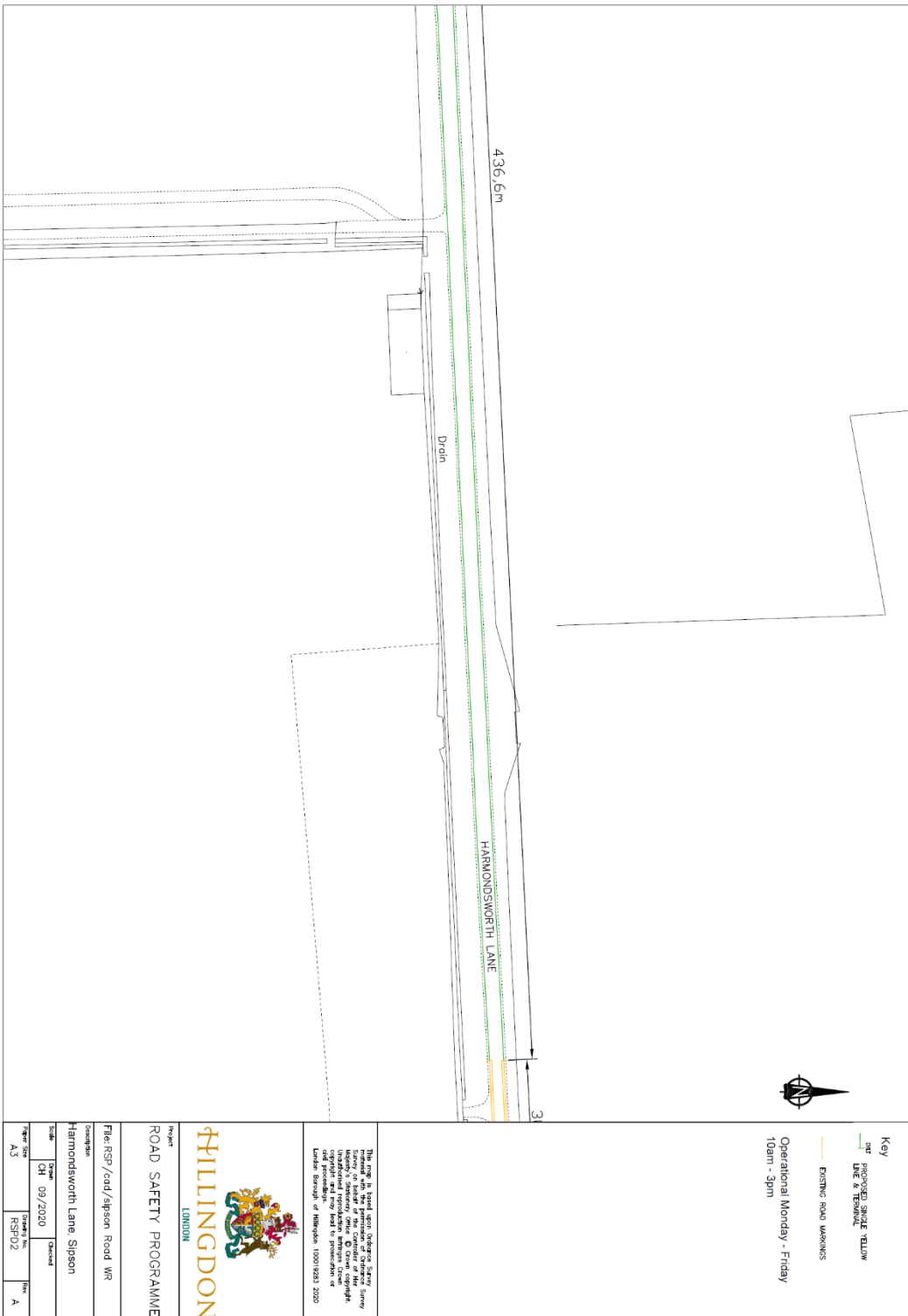

APPENDIX B

Appendix B No 3

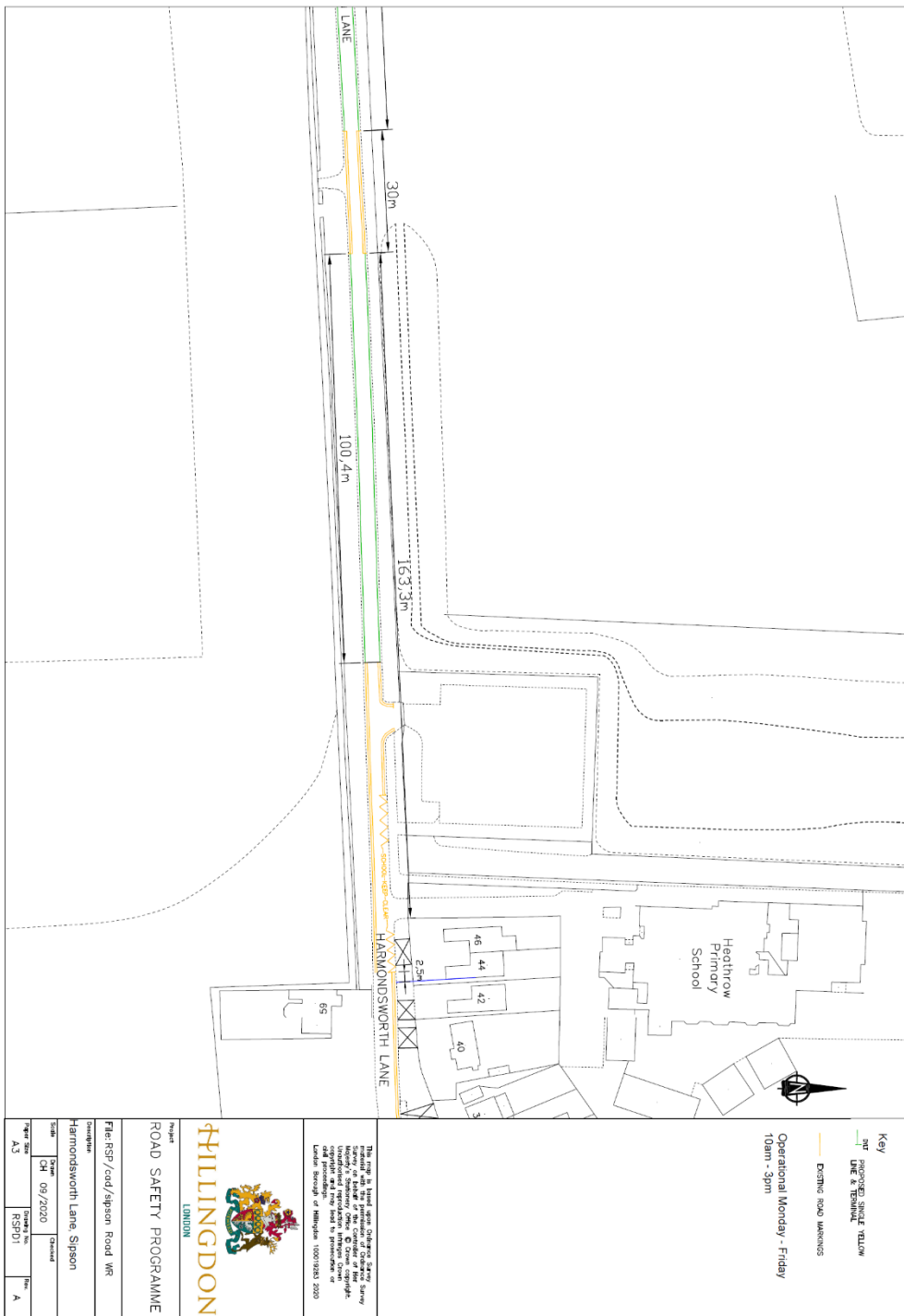

APPENDIX B

Appendix C – revised proposal

