



Democratic Services

Location: Phase II
Ext: 0185
DDI: 01895 250185
CMD No: 887

**To: COUNCILLOR JONATHAN BIANCO
CABINET MEMBER FOR PROPERTY, HIGHWAYS
AND TRANSPORT**

c.c. All Members of the Property, Highways and
Transport Select Committee
c.c. Caroline Haywood – Place Directorate
c.c. Perry Scott – Corporate Director of Place
c.c. Ward Councillors for South Ruislip

Date: 21 August 2023

Non-Key Decision request

Form D

MANNINGTREE ROAD / BRAINTREE ROAD, RUISLIP - OBJECTION TO PROPOSED WAITING RESTRICTIONS

Dear Cabinet Member

Attached is a report requesting that a decision be made by you as an individual Cabinet Member. Democratic Services confirm that this is not a key decision, as such, the Local Authorities (Executive Arrangements) (Meetings and Access to Information) (England) Regulations 2012 notice period does not apply.

You should take a decision **on or after Wednesday 30 August 2023** in order to meet Constitutional requirements about publication of decisions that are to be made. You may wish to discuss the report with the Corporate Director before it is made. Please indicate your decision on the duplicate memo supplied, and return it to me when you have made your decision. I will then arrange for the formal notice of decision to be published.

Liz Penny
Democratic Services Officer

Title of Report: Manningtree Road / Braintree Road, Ruislip - Objection to Proposed Waiting Restrictions

Decision made:

Reasons for your decision: (e.g. as stated in report)

Alternatives considered and rejected: (e.g. as stated in report)

Signed Date.....

Cabinet Member for Property, Highways and Transport

MANNINGTREE ROAD / BRAINTREE ROAD, RUISLIP - OBJECTION TO PROPOSED WAITING RESTRICTIONS

Cabinet Member(s)	Councillor Jonathan Bianco
Cabinet Portfolio(s)	Property, Highways and Transport
Officer Contact(s)	Caroline Haywood, Place Directorate
Papers with report	Appendix A – location plan Appendix B – plan of proposal

HEADLINES

Summary	To inform the Cabinet Member that objections have been received to the proposed 'At Any Time' waiting restrictions on the junction of Manningtree Road and Braintree Road, Ruislip.
Putting our Residents First	The request can be considered as part of the Council's annual programme of road safety initiatives.
Financial Cost	The cost associated with the recommendations to this report is estimated at £474 and will be managed within existing revenue budgets for the Transportation Service.
Relevant Select Committee	Property, Highways and Transport Select Committee
Relevant Ward(s)	South Ruislip

RECOMMENDATIONS

That the Cabinet Member for Property, Highways and Transport:

- 1. Considers the objections received from the statutory consultation for the proposed 'At Any Time' waiting restrictions on the junction of Manningtree Road and Braintree Road, Ruislip; and**
- 2. Approves the introduction of the proposed 'At Any Time' waiting restrictions on the junction of Manningtree Road and Braintree Road, Ruislip, as shown at Appendix B.**

Reasons for recommendations

To improve access on the junction of Manningtree Road and Braintree Road yet still maintain some parking provision for residents and visitors.

Alternative options considered / risk management

The Council could decide not to proceed with the installation of the 'At Any Time' waiting restrictions as advertised.

Democratic compliance / previous authority

None at this stage.

Select Committee comments

None at this stage.

SUPPORTING INFORMATION

1. Manningtree Road and Braintree Road are mainly residential roads, with Braintree Road having a small industrial estate at the end of the road close to its junction with Manningtree Road. Both roads are within South Ruislip Ward. Both roads lead onto Victoria Road, a main route to Eastcote and the A40. A plan of the area is shown on Appendix A to this report.
2. The Council received a request from a local Ward Councillor asking for measures to remove obstructive parking on the junction of Manningtree Road and Braintree Road; as a consequence a detailed site investigation was undertaken by Council officers.
3. Officers observed that vehicles were parked close to the junction up to the dropped kerbs. Vehicles parking on Braintree Road restricted sight lines for vehicles exiting Manningtree Road.
4. As a result of the site observations, a proposal was developed to install double yellow lines on the junction. This will still maintain parking in the rest of the road but improve access and pedestrian safety. The proposed waiting restrictions are shown on the plan attached as Appendix B to this report.
5. The Cabinet Member agreed to take the proposal through the statutory 21-day consultation process, which involved the placing of advertisements in the local press and the display of public notices on site. During this period the Council received two objections to the proposal.
6. The first objector stated *"I consider that the plan is a waste of the LBH's finances. The existing businesses have always been sensitive to the needs of local residents and, working directly opposite the said junction, obstructive parking is rare with a capital R. No*

obstruction is ever caused to the Manningtree/Braintree Road junction to the East as there is simply nothing to obstruct. There WERE occasions when the similar junction to the West was occasionally obstructed BUT not since the house at this junction made their front garden their domestic parking space.

I accept that vehicular traffic has been increased. This is because the LBH have allowed ADL bodyworks to occupy business premises on the Industrial Estate which comes with a limited number of parking spaces. Since they have been there, they consistently park vehicles on adjacent roads to the Estate including Manningtree, Braintree, Tiptree and Victoria Roads causing, I would imagine, the residents increased angst as many of these damaged vehicles can stay in situ for weeks. There is an allied 'knock on' effect for the vehicles of the preexisting businesses now needing to park somewhere else too!

If you must proceed, then the intended extent of the double yellow lines is far in excess of what is required, and I am still unsure about what exactly is being obstructed?

I suggest another site visit to assess the scene before money is wasted on a grandiose scheme to solve a problem that rarely, if ever, exists in the light of recent developments. Is there more cars parked - YES but I do not agree that the imposition of double yellow lines is warranted or necessary. Bottom line is I object on grounds of actual necessity and, as an LBH resident, the considerable cost of implementation."

7. The second objector stated "I would like to object (to) this proposed double line. We as business are already suffering a lot and now with these restrictions on our road, will be very difficult to survive. We have many customers and suppliers who park their vehicles there for few minutes to drop and go as parking is very less on the street. It will be helpful for our business if you don't go ahead with this proposal."
8. The local Ward Councillors have been consulted, and all three have responded supporting the proposed yellow lines.
9. After careful consideration of comments received from the statutory consultation and the views of the local Ward Councillors, it is recommended that the Cabinet Member agrees to proceed with the proposed 'At Any Time' waiting restrictions on the junction of Manningtree Road and Braintree Road in Appendix B to this report.

Financial Implications

The cost associated with the recommendations to this report is estimated at £474 and will be managed within existing revenue budgets for the Transportation Service.

RESIDENT BENEFIT & CONSULTATION

The benefit or impact upon Hillingdon residents, service users and communities

The effect of introducing the proposed waiting restrictions on Manningtree Road and Braintree Road will be that access and safety is maintained whilst maintaining parking for residents.

Consultation carried out or required

Consultation has been carried out on this proposal through a notice on site and in the local press. Local Ward Councillors have also been consulted.

CORPORATE CONSIDERATIONS

Corporate Finance

Corporate Finance has reviewed the recommendations to this report and concurs with the financial implications as set out above.

Legal

The Borough Solicitor confirms that there are no legal impediments to the Cabinet Member agreeing the recommendations set out in the report which are in accordance with the outcome of the statutory consultation.

Infrastructure / Asset Management

There are no property implications resulting from the recommendations set out in this report.

Comments from other relevant service areas

None at this stage.

BACKGROUND PAPERS

- Traffic order
- Objection emails

TITLE OF ANY APPENDICES

Appendix A - location plan
Appendix B - plan of proposal

Appendix A - location plan

APPENDIX A

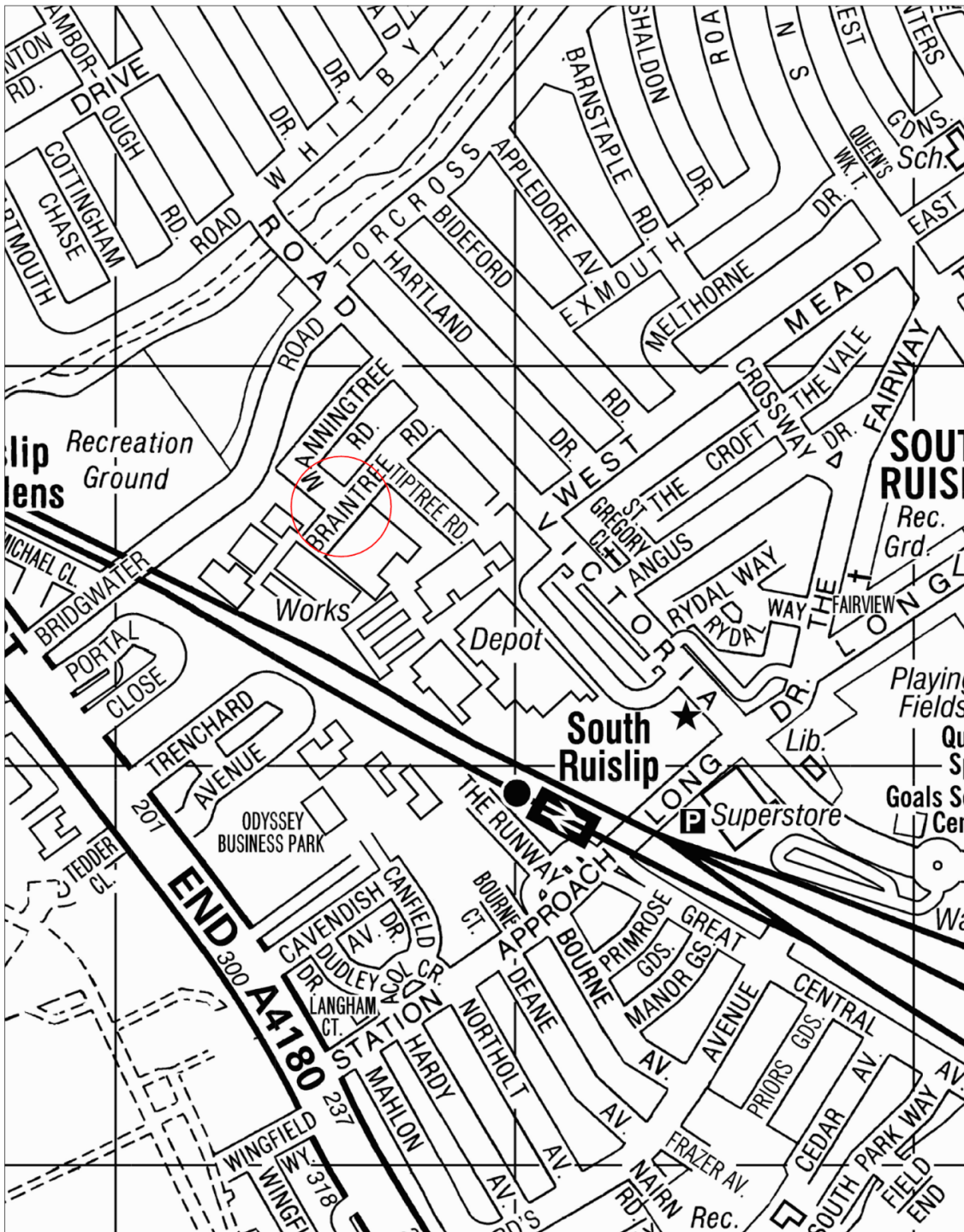

© Crown copyright and database rights 2023 Ordnance Survey 100019283

 Manningtree Road / Braintree Road, Ruislip

Appendix B - plan of proposal

